

SOLDERABLE COOLERS FOR MOLD POWER

(ソルダーマウンティングピン付FIN) PUシリーズ

ユーザーの立場から設計されたディップ放熱器群

MOLD POWER COOLERS (モールドパワーTR用放熱器)

推奨基板取付穴

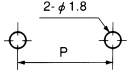

PUE10 <H0343>

L寸法	熱抵抗 (K/W)	重量 (g)	表面積 (cm ²)
A	25	28.9	3.6
B	30	25.5	3.9

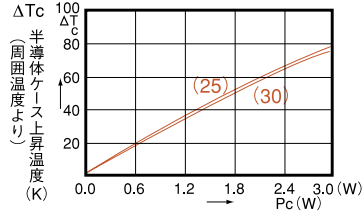
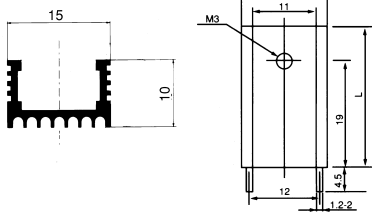

PUS15 <H0344>

L寸法	熱抵抗 (K/W)	表面積 (cm ²)	重量 (g)
25	25.3	23	4.9

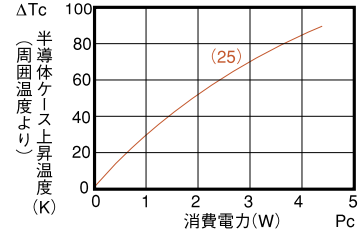
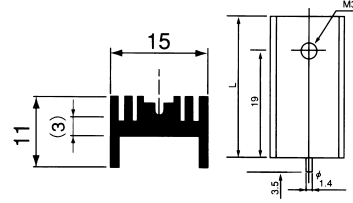

PUE16 <H0345>

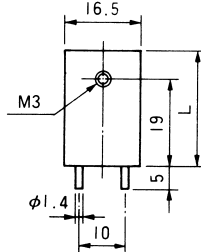
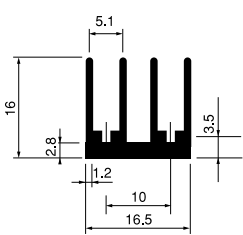

L寸法	熱抵抗 (K/W)	表面積 (cm ²)	重量 (g)
25	17.3	42	7.6
30	15.9	50	9.2

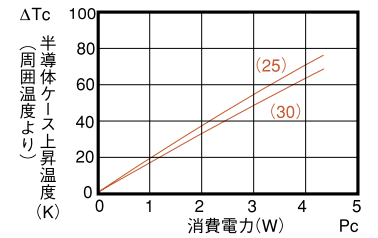

PUE26 <H0346>

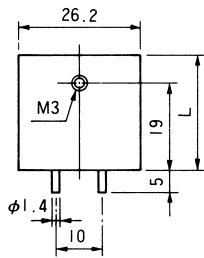
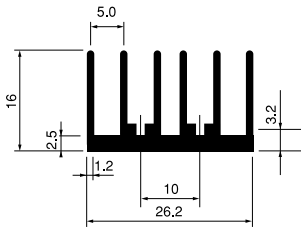

L寸法	熱抵抗 (K/W)	表面積 (cm ²)	重量 (g)
25	12.1	65	11
30	11.6	77	13

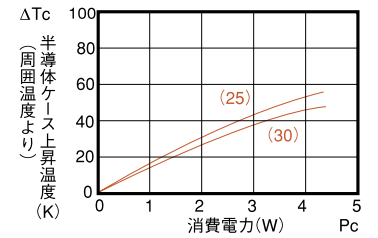

PUE36 <H0347>

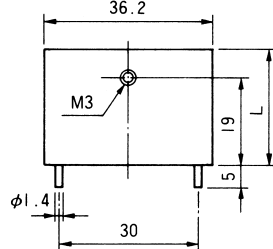
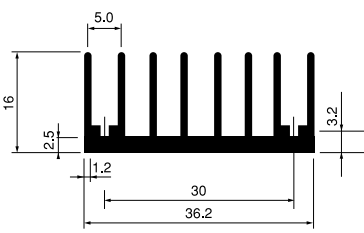

L寸法	熱抵抗 (K/W)	表面積 (cm ²)	重量 (g)
25	11.2	86	16
30	9.30	103	19

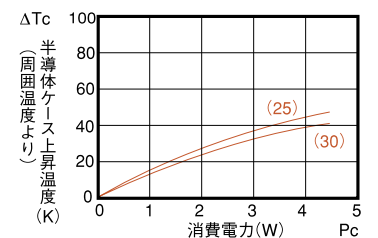

PUE46 <H0348>

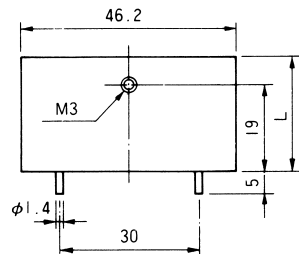
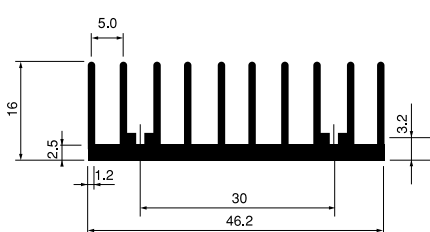

L寸法	熱抵抗 (K/W)	表面積 (cm ²)	重量 (g)
25	9.70	107	19
30	8.90	127	23

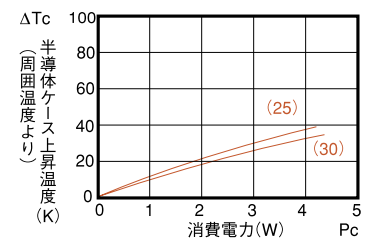

PUE56 <H0349>

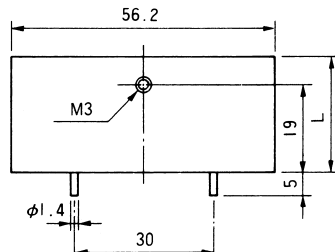
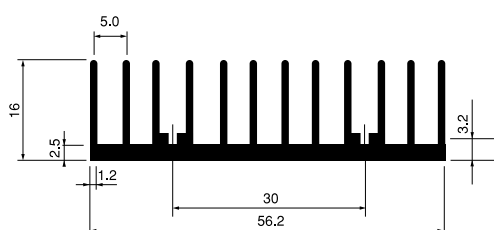

L寸法	熱抵抗 (K/W)	表面積 (cm ²)	重量 (g)
25	8.85	130	24
30	7.39	154	28

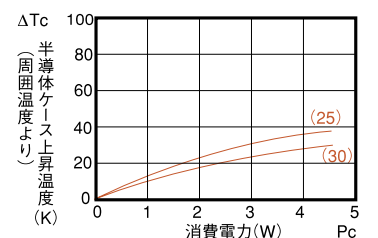

SOLDERABLE COOLERS FOR MOLD POWER

(ソルダーマウンティングピン付FIN) PUシリーズ

生産効率アップを第一に設計されたプリント配線板用放熱器

MOLD POWER COOLERS (モールドパワーTR用放熱器)

推奨基板取付穴

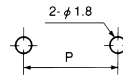

PUG16 <H0350>

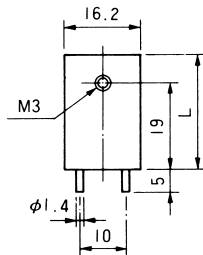
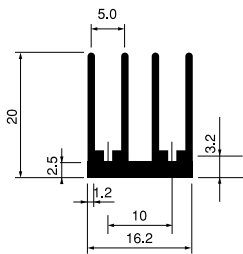

L寸法	熱抵抗 (K/W)	表面積 (cm ²)	重量 (g)
25	14.8	52	9.5
30	13.6	62	11

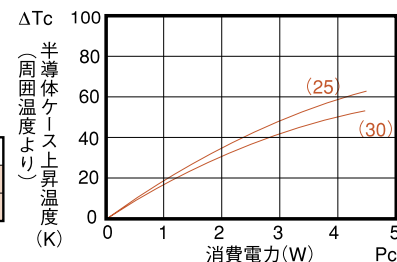

PUG26 <H0351>

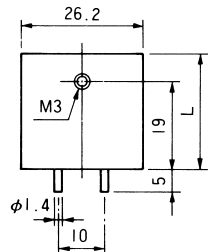
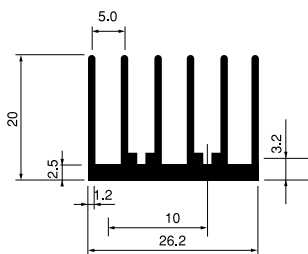

L寸法	熱抵抗 (K/W)	表面積 (cm ²)	重量 (g)
25	11.6	77	14
30	10.5	92	16

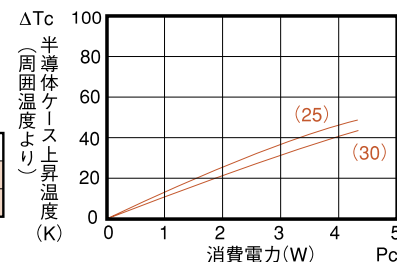

PUG36 <H0352>

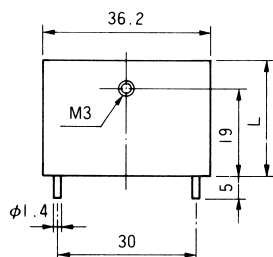
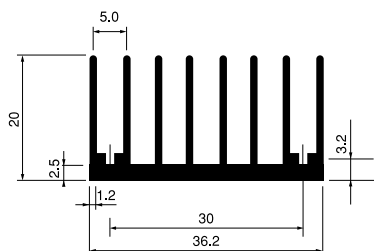

L寸法	熱抵抗 (K/W)	表面積 (cm ²)	重量 (g)
25	10.4	104	19
30	8.90	123	22

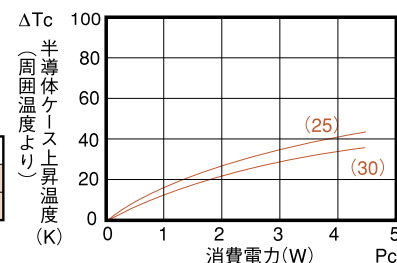

PUG46 <H0353>

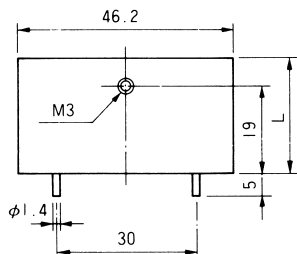
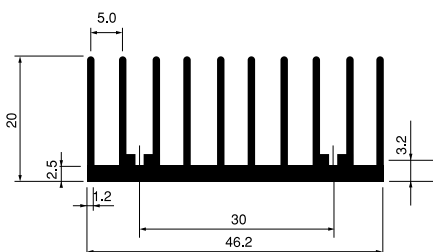

L寸法	熱抵抗 (K/W)	表面積 (cm ²)	重量 (g)
25	8.30	130	23
30	7.45	155	28

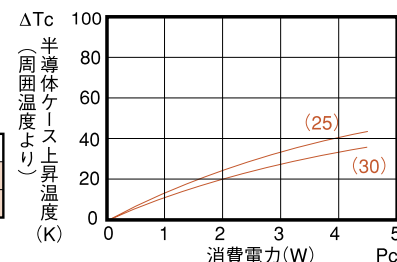

PUG56 <H0354>

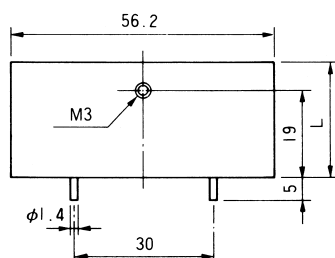
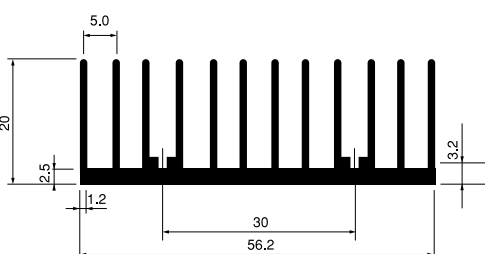

L寸法	熱抵抗 (K/W)	表面積 (cm ²)	重量 (g)
25	6.40	156	27
30	6.00	186	33

